

User's Manual KETOSCAN LITE

1 Components

KETOSCAN LITE, AA battery(2), mouthpiece(3), User's Manual

2 Product Description

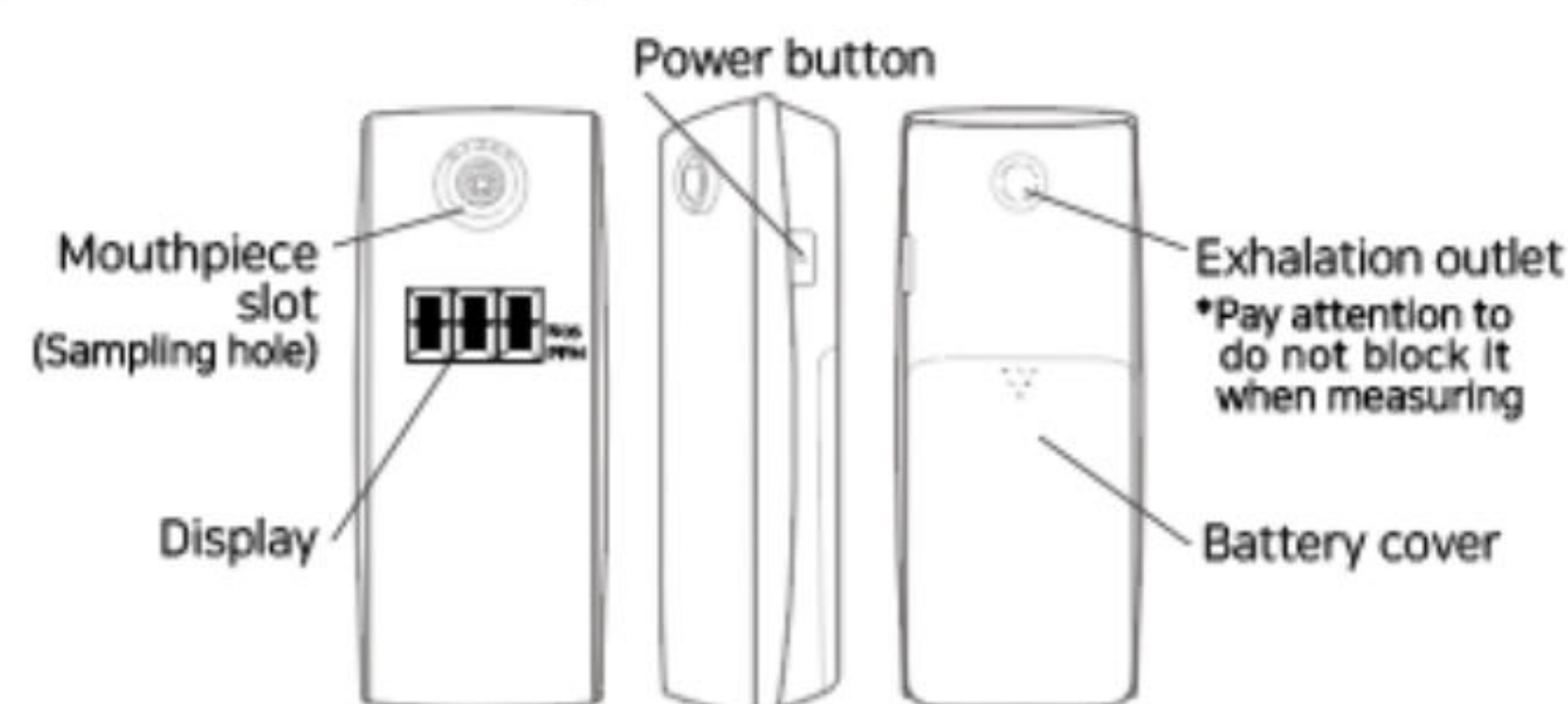

3 Precautions

- KETOSCAN Lite is **unavailable to connect with the mobile app and has no BLUETOOTH communication.**

You must manually input your data to use the app.

- The device gets locked after measuring 300 tests to maintain accuracy. If the device gets locked, please contact the nearest service center or through the app's 'Service Center menu' or the place of your purchase.

- The test result can be affected, when measuring after drinking no other than water, such as coffee, juice, etc. also smoking and brushing teeth. Please wait at least 30 minutes before the test after the above actions.

- The alcohol can influence the test result, so avoid testing within 24 hours of drinking and hangover.

- The accuracy of the sensor can be decreased when the unit is not used for 6 to 12 months.

In this case, please contact the nearest service center or through the app's 'Service Center menu' or the place of your purchase.

6 Level Guide

KETOSCAN Lite measures your breath acetone concentration in PPM(Parts Per Million). Refer to the below chart to track your level, bodyfat burning rate based on your acetone reading.

| Ketosis State | Level | Acetone Reading | Bodyfat burning rate |
|---|----------|-----------------|----------------------|
| No or Low | LEVEL 0 | 0 ppm | 0.00 oz/hour |
| | LEVEL 1 | 1 ppm | 0.00 oz/hour |
| You are not in ketosis. | | | |
| Beginning | LEVEL 2 | 2 ppm | 0.05 oz/hour |
| | LEVEL 3 | 3 ppm | 0.08 oz/hour |
| | LEVEL 4 | 4 ppm | 0.11 oz/hour |
| You are at early stage of ketosis. | | | |
| Stable | LEVEL 5 | 5 ppm | 0.13 oz/hour |
| | LEVEL 6 | 6 ppm | 0.16 oz/hour |
| | LEVEL 7 | 7 ppm | 0.19 oz/hour |
| | LEVEL 8 | 8 ppm | 0.21 oz/hour |
| | LEVEL 9 | 9 ppm | 0.24 oz/hour |
| You are at a stable level of ketosis. | | | |
| Optimal | LEVEL 10 | 10 ~ 40 ppm | 0.25 oz/hour |
| You are in an optimum level of ketosis. | | | |

·The maximum acetone reading on the unit is 40ppm, and it will be blinking if your reading is above than 40ppm.

4 Display Message

blb Start to blow

Blow into the mouthpiece(or drinking straw) until the unit vibrates.

5dl Sensor Conditioning test Completed

Sensor Conditioning test Completed

Wait few seconds for the main test

5En Sensor replacement required(Blocked to operate)

The unit has maximum of 300 tests, so sensor replacement service is needed to maintain it's accuracy. Please contact the nearest service center or through the app's 'Service Center menu' or the place of your purchase for the service.

6RE Low Battery Warning

Replace AA Alkaline batteries to a new one.

Er,2 Sensor error

Er 2(Error 2) message is displayed when an error on the sensor is occurred. Please contact the nearest service center or through the app's 'Service Center menu' or the place of your purchase.

5 How to use

①Put a mouthpiece(or drinking straw) on a sampling hole.

Press and hold the power button for 2 seconds to turn the unit on.

②The available number of tests and the previous test results will be displayed on the screen.

③Wait unit blb showed on the screen then start to blow continuously until the unit vibrates. 5dl will be displayed as the sensor conditioning test is completed.

Count down again, and then the unit requests you to blow one more time for the main test. Blow continuously until the unit vibrates.

④The test result will be displayed and turns off in 15 seconds automatically.

⑤To turn the unit off forcibly, press and hold the power button for 2 seconds.

7 Product Specification

| | |
|--------------------------|---|
| Sensor Type | High resolution acetone gas sensor |
| Display Unit | PPM(Parts Per Million) |
| Measurement Range | OPPM ~ 40PPM |
| Accuracy | Less than 5ppm: +/-0.5ppm On or above 5ppm: +/-10% |
| Battery | 1.5V AAsize alkaline battery 2pcs |
| Analyzing Time | Within 5 seconds |
| Mouthpiece | Provided disposable mouthpiece or Standard drinking straw (0.7cm or 0.28 Inch Diameter) |
| Sensor Replacement Cycle | 300 measurements |
| Storage Temperature | 5°C ~ 50°C (41°F to 122°F) |
| Operational Temperature | 10°C ~ 40°C(50°F to 104°F) |
| Certificate | FCC, CE, FDA Class 1 |

8 Sensor Replacement Service

The sensor replacement service offers completely new and calibrated sensor to the unit.

This process is a special care solution allowing you to manage the unit as if it is new for long-term period. Also, by simply replacing the sensor it will reduce the cost compared to replacing the whole unit.

If the unit displays 5En and blb, please contact the nearest service center or through the app's 'Service Center menu' or the place of your purchase.

·What is sensor conditioning test?

Sensor conditioning testing is a patented process that protects the sensor from environmental materials & gases. It ensures test accuracy and the long-term stability of your KETOSCAN sensor. This process will not be counted as test, so you don't have to worry about the 300-maximum test.

·Recall data on the unit

Turn the unit on, then press the power button once when the screen displays 8.8.8 The available number of testing and the latest testing result will be toggled on the screen.

·Make your own keto logbook

Input your readings, take a picture and track your data on KETOSCAN LITE mobile App. Available on the Google play store and the App store.

·Sync your fitness/calorie counter app with the KETOSCAN Lite app.

The information you enter into your Google Fit, Apple Health and FatSecret will automatically sync into the KETOSCAN Lite app.

| Sync with | To recall my |
|--------------|---|
| Google Fit | Weight, Calories consumed |
| Apple Health | Weight, Calories burned/consumed |
| FatSecret | Weight, Calories burned/consumed and macronutrients ratio |



FCC compliance information

THIS DEVICE COMPLIES WITH PART 15 OF THE FCC RULES.

Operation is subject to the following two conditions:

- (1) This device may not cause harmful interference, and
 - (2) This device must accept any interference received, including interference that may cause undesired operation.
- Note: This equipment has been tested and found to comply with the limits for a Class B digital device, pursuant to part 15 of the FCC Rules. These limits are designed to provide reasonable protection against harmful interference in a residential installation. This equipment generates, uses, and can radiate radio frequency energy and, if not installed and used in accordance with the instructions, may cause harmful interference to radio communications. However, there is no guarantee that interference will not occur in a particular installation. If this equipment does cause harmful interference to radio or television reception, which can be determined by turning the equipment off and on, the user is encouraged to try to correct the interference by one or more of the following measures:
- Reorient or relocate the receiving antenna.
 - Increase the separation between the equipment and receiver.
 - Connect the equipment into an outlet on a circuit different from that to which the receiver is connected.
 - Consult the dealer or an experienced radio/TV technician for help.

Modifications not expressly approved by the manufacturer may void the user's authority to operate the equipment under FCC rules.

Limited ONE year warranty

Warranty coverage

Sentech GMI Corp. warrants this product against defects in materials and workmanship under normal use for a period of ONE(1) YEAR from the date of retail purchase by the original end-user purchaser("Warranty Period"). Except as provided in the preceding sentence or applicable law, Sentech GMI Corp. provides this product "as is". If a defect arises and a valid claim is received by Sentech GMI Corp. within the Warranty Period, at its option, Sentech GMI Corp. will either (1) repair the product, (2) exchange the product with a product that is new or which has been manufactured from new or serviceable used parts and is at least functionally equivalent to the original product, or (3) refund the purchase price of the product. When a refund is given, the product for which the refund is provided must be returned to Sentech GMI Corp. or Seller and becomes Sentech GMI Corp. or Seller property. This warranty is limited to the original end-user purchaser and is not transferable to, or enforceable by, any subsequent owner.

No Sentech GMI Corp reseller, agent, or employee is authorized to make any modification, extension, or addition to this warranty. If any term is held to be illegal or unenforceable, the legality or enforceability of the remaining terms shall not be affected or impaired.

EXCEPT AS PROVIDED IN THIS WARRANTY AND TO THE MAXIMUM EXTENT PERMITTED BY LAW, Sentech GMI Corp IS NOT RESPONSIBLE FOR DIRECT, SPECIAL, INCIDENTAL OR CONSEQUENTIAL DAMAGES UNDER ANY LEGAL THEORY, INCLUDING BUT NOT LIMITED TO LOSS OF USE; LOSS OF REVENUE OR INCOME; LOSS OF ACTUAL OR ANTICIPATED PROFITS (INCLUDING LOSS OF PROFITS FROM A CONTRACT); LOSS OF THE USE OF MONEY; LOSS OF ANTICIPATED SAVINGS; LOSS OF BUSINESS; LOSS OF OPPORTUNITY; LOSS OF GOODWILL, OR LOSS OF REPUTATION.

Some countries, states and provinces do not allow the exclusion or limitation of incidental or consequential damages or allow limitations on how long an implied warranty or condition may last, so the above limitations or exclusions may not apply to you. This warranty gives you specific legal rights, and you may also have other rights that vary by country, state or province. This Limited Warranty is governed by and construed under the laws of the country in which the product purchase took place.

For warranty & technical service Please contact;

SENTECH GMI

SENTECH GMI Corp. #1713, #1714, 416, Hwagok-ro, Gangseo-gu, Seoul, Republic of Korea 07548

Tel: +82 2 6929 1310

www.ketoscan.com sales@sentechgmi.com